

DATE PLOTTED: 10 January 2022 9:33 AM BY: IAN LEASK
 XREFS: XR-NZ0122023-AR-ARCH LAYOUT, XR-NZ0122023-CI-PROPERTY BOUNDARIES, XR-NZ0122023-CI-EXISTING SERVICES, XR-NZ0122023-SU-TOPO, XR-NZ0122023-CI-EX SURFACE, XR-NZ0122023-CI-AERIAL, 2021, XR-NZ0122023-CI-SERVICES
 CAD File: H:\2023\NZ0122023-CI-EXISTING SERVICES\XR-NZ0122023-CI-EXISTING SERVICES\XR-NZ0122023-CI-0300.dwg

Wellington Water
 Accepted Drainage and Water Plans Wellington Water Ltd
 Laid new 160 mm PE SDR 17 Public Wastewater Main + 1 manhole
 Date: 13 December 2021
 Public Drainage Permit: 507136
 Location: 124 - 130 Coromandel Street.

Please Note that Acceptance is subject to the following Conditions:
General

- The contractor/developer shall comply with the design and construction requirements of the Wellington City Council Code of Practice for Land Development and in Particular the Regional Standards and the Regional Specification for Water Services and the requirements of the public drainage permit.
- Where changes are required during construction approval will be required from Wellington Water.
- The new public main is to be CCTV inspected after building construction to record any damage occurs as a result of the building work. If any damage occur the applicant will be responsible for rectifying as soon as possible.
- A minimum of 48 hours' notice is given to contract officer, WWL, Charles Puha; Ph 04 910 3800 prior to commencement or to final inspection work of drainage work.

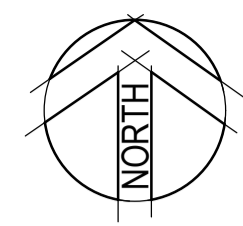

- LEGEND**
- PROPERTY BOUNDARY
 - STORMWATER
 - STORMWATER LATERAL
 - STORMWATER MANHOLE
 - SUMP
 - SEWER
 - SEWER LATERAL
 - SEWER MANHOLE
 - + DOWNPIPE
 - SUBSOIL DRAIN (FOR RETAINING WALLS)
 - SECONDARY FLOWPATH
 - TRAPPED YARD SUMP
 - AQUACOMB AQUAPIT TRAPPED SUMP
 - THRESHOLD DRAIN - REFER ARCHITECTURAL DRAWINGS FOR DETAILS
- EXISTING SERVICES LEGEND**
- SW STORMWATER
 - S SANITARY SEWER
 - W WATER
 - G GAS
 - E OH POWER - OVERHEAD
 - T COMMS
 - POWER POLE
 - STORMWATER MANHOLE
 - SEWER MANHOLE
 - WATER MANIFOLD

CONTRACTOR TO POTHOLE ALL CROSSING SERVICES AND CONFIRM NO CLASHES PRIOR TO PIPE LAYING

- EXISTING SERVICES NOTES:**
- THE INFERRED LOCATIONS OF UNDERGROUND SERVICES HAVE BEEN POSITIONED BY EITHER GROUND SURVEY AND/OR DIGITISED FROM EXISTING RECORDS PROVIDED BY LOCAL AUTHORITIES AND UTILITY SERVICE PROVIDERS, AND CONSEQUENTLY CARRIES THEIR ACCURACY DISCLAIMERS. NO LIABILITY IS ASSUMED FOR THE ACCURACY OF THE PLOTTED UTILITY SERVICES. NOT ALL THE EXISTING SERVICES MAY BE SHOWN.
 - THE LOCATION OF ALL SERVICES MUST BE CONFIRMED WITH THE RESPECTIVE LOCAL AUTHORITY AND/OR SERVICE PROVIDER PRIOR TO ANY GROUND DISTURBANCES.
 - CONTRACTOR TO IDENTIFY ALL EXISTING SERVICES ON-SITE PRIOR TO CONSTRUCTION. THE CONTRACTOR IS RESPONSIBLE FOR PROTECTING THESE SERVICES FOR THE DURATION OF THE SITE CONTRACT.
 - MARK OUT ALL EXISTING SERVICES AND POTHOLE WHERE REQUIRED BEFORE WORK BEGINS. ADVISE THE ENGINEER WHERE ANY DISCREPANCIES OCCUR.
- NOTES**
- ALL CO-ORDINATES ARE IN TERMS OF NZGD 2000 - WELLINGTON CIRCUIT.
 - ELEVATIONS ARE IN TERMS OF MSL (WELLINGTON 1953).
 - ALL WORK SHALL BE CARRIED OUT IN ACCORDANCE WITH THE HEALTH AND SAFETY AT WORK ACT 2015.
 - ALL EXISTING, ABANDONED SEWER AND STORMWATER PIPES ARE TO BE GROUTED.
 - ALL SS PRIVATE CONNECTIONS ARE TO BE DN100 uPVC SN8 UNLESS SHOWN OTHERWISE.
 - ALL SW PRIVATE CONNECTIONS ARE TO BE DN100 uPVC SN8 UNLESS SHOWN OTHERWISE.
 - SINGLE SUMP LEAD TO BE DN150 uPVC SN8, DOUBLE SUMP LEAD TO BE DN225 uPVC SN8.
 - ALL MANHOLES ARE TO BE 1050mm UNLESS SHOWN OTHERWISE.
 - ALL WORK SHALL BE CARRIED OUT IN ACCORDANCE WITH:
 - 9.1. WELLINGTON CITY COUNCIL ENGINEERING CODE OF PRACTICE FOR LAND DEVELOPMENT,
 - 9.2. THE CONDITIONS OF THE COUNCIL ENGINEERING APPROVAL DOCUMENTATION, AND;
 - 9.3. WELLINGTON WATER REGIONAL SPECIFICATION FOR WATER SERVICES 2021.
 - 9.4. WELLINGTON WATER REGIONAL STANDARD FOR WATER SERVICES 2021.
 - ALL WORK TO BE CARRIED OUT IN ACCORDANCE WITH ALL TRENCHING WORK IS TO COMPLY WITH THE NATIONAL CODE OF PRACTICE FOR UTILITIES ACCESS TO THE TRANSPORT CORRIDORS DOCUMENT.
 - THE CONTRACTOR SHALL GIVE A MINIMUM OF 48 HOURS NOTICE TO THE WELLINGTON WATER SITE INSPECTOR PRIOR TO COMMENCEMENT OF WORK.
 - THE CONTRACTOR SHALL PROVIDE THE WELLINGTON WATER SITE INSPECTOR WITH A LIST OF SITE HAZARDS AND A SITE SAFETY INDUCTION A MINIMUM OF 48 HOURS PRIOR TO COMMENCEMENT OF WORK.
 - THE CONTRACTOR SHALL CONFIRM THE ALIGNMENT OF THE NEW PIPES, IN CONSULTATION WITH THE ENGINEER, AFTER ALL EXISTING SERVICES HAVE BEEN LOCATED.
 - REFER TO ARCHITECTS DRAWINGS FOR INTERNAL SERVICES.
 - CONTRACTOR TO CONFIRM WITH POWERCO THE GAS SHUT OFF REQUIREMENTS PRIOR TO REMOVAL.
 - WATER AND UTILITIES OMITTED FOR CLARITY - REFER TO DRAWING NZ0122023-CI-0300.
 - AQUACOMB SYSTEM TO BE INSTALLED IN ACCORDANCE WITH MANUFACTURER'S GUIDELINES AND SPECIFICATIONS.

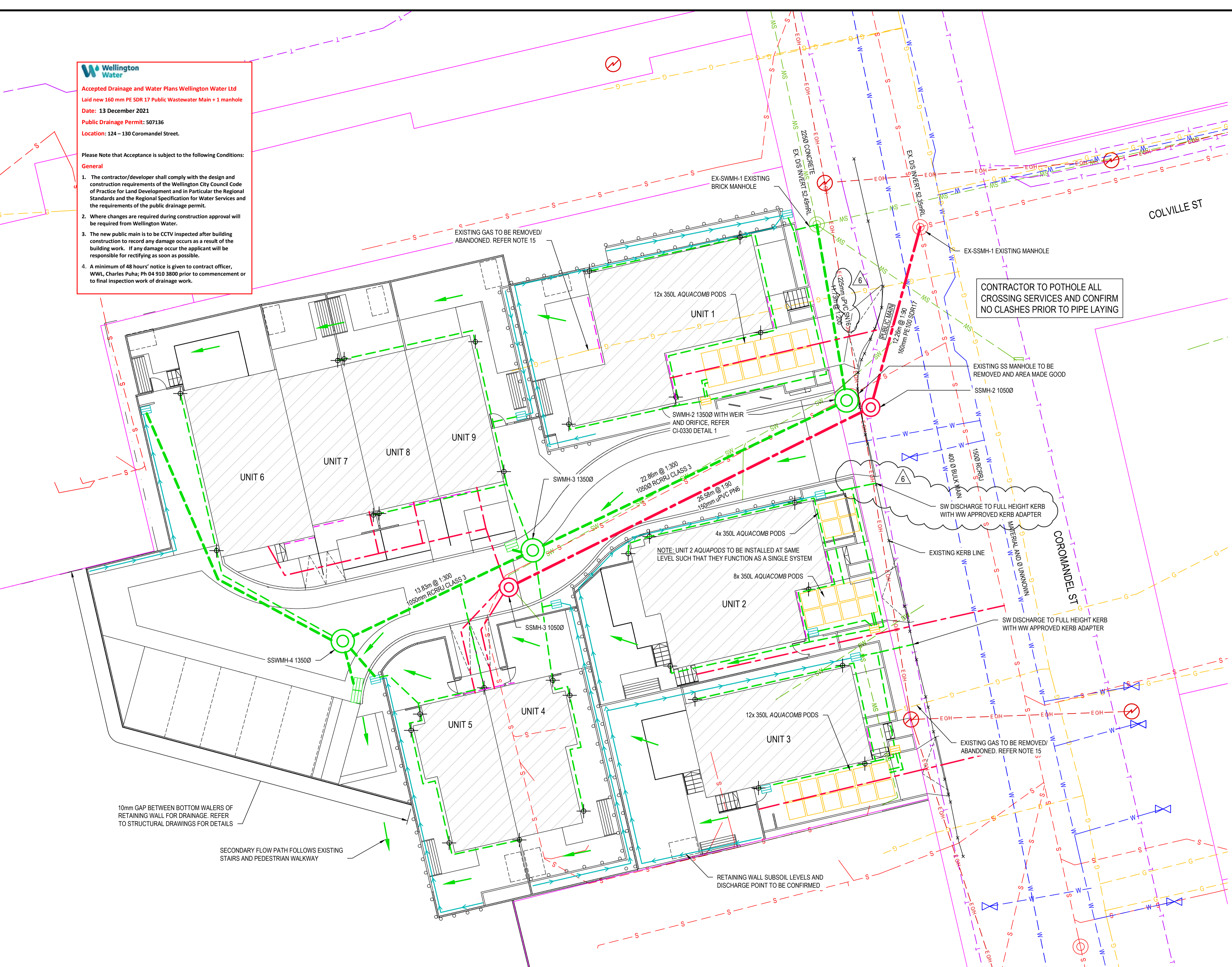
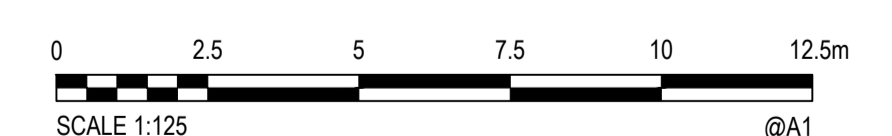

Rev.	Date	Description	Des.	Verif.	Appd.
6	10/01/2022	FOR APPROVAL	IL	DB	DB
5	15/12/2021	FOR APPROVAL	IL	DB	DB
4	2/12/2021	FOR APPROVAL	IL	DB	DB
3	11/30/2021	FOR APPROVAL	IL	DB	DB
2	23/11/2021	FOR REVIEW	IL	DB	DB
1	29/10/2021	FOR REVIEW	IL	DB	DB



© Cardno Limited All Rights Reserved.
 This document is produced by Cardno Limited solely for the benefit of and use by the client in accordance with the terms of the retainer. Cardno Limited does not and shall not assume any responsibility or liability whatsoever to any third party arising out of any use or reliance by third party on the content of this document.

Cardno
 Cardno (NZ) Limited
 Level 5, IBM Building, 25 Victoria Street
 Petone, Lower Hutt 5012
 Tel: 04 478 0342
 Web: www.cardno.co.nz

Drawn	Date	Client
IL	29/10/2021	KAINGA ORA
Checked	Date	Project
DB	29/10/2021	124-130 COROMANDEL ST
Designed	Date	ENGINEERING SERVICES
IL	29/10/2021	
Verified	Date	Title
DB	29/10/2021	STORMWATER AND SEWER PLAN
Approved	Date	
DB	11/30/2021	

Status	FOR APPROVAL	
NOT TO BE USED FOR CONSTRUCTION PURPOSES		
DATUM	Scale	Size
Wgtn2000	1:125	A1
Drawing Number	Revision	
NZ0122023-CI-0300	6	