



Fence Legend

- 1.8TP** 1.8m high Timber paling fence
150x19mm H3.2 vertical palings,
5mm spacing.
- 0.9TP** 0.9m high Timber paling fence
150x19mm H3.2 vertical palings,
5mm spacing.
- 1.5HS** 1.5m high Horizontal slatted
100x27mm H3.2 horizontal slats,
15mm spacing.
- HR** 1.2m Open aluminium gate
0.25m high aluminium gate
(DuralPanel Deck) (or equivalent),
open aluminium gate, self-closing
hinges, child proof latch, black
powder coat finish
- Handrail**
50mm diameter 1.1m high metal
handrail (NZBC D1 compliant)

Furniture & Services Legend

- WL** Washing Line
- B** Rubbish/ Recycling Bins
- MB** Mailbox
- SA** Shed Storage Area
- TA** Retention tank

Note - Indicative tank location for existing plan for house. TBC when landscape remediation plan for existing house is prepared. Any additional hardscaping to be permeable paving.

SL2100029

APPROVED

Moxie

25/02/2022

Project No. | 20207 | Drawing no. | CC-A813 | Rev. | RC-F

Scale | 1:250 @ A3 | Project No. | 20207 | Drawing no. | CC-A813 | Rev. | RC-F

Title
Fencing & Furniture

Project
Kāinga Ora Development of 28 - 34
Clotworthy Crescent

Rev.	Date	Notes
RC-F	18/02/22	Resource Consent s92 update
RC-E	15/11/21	Resource Consent s92
RC-D	05/09/21	Resource Consent OA
RC-C	02/09/21	Resource Consent
RC-B	29/07/21	Resource Consent

Consultants
Civil Engineer - Cook Costello
Geotech Engineer - Cook Costello
Planner - Barker & Associates
Landscaping - Context Architects



Client



context Architects

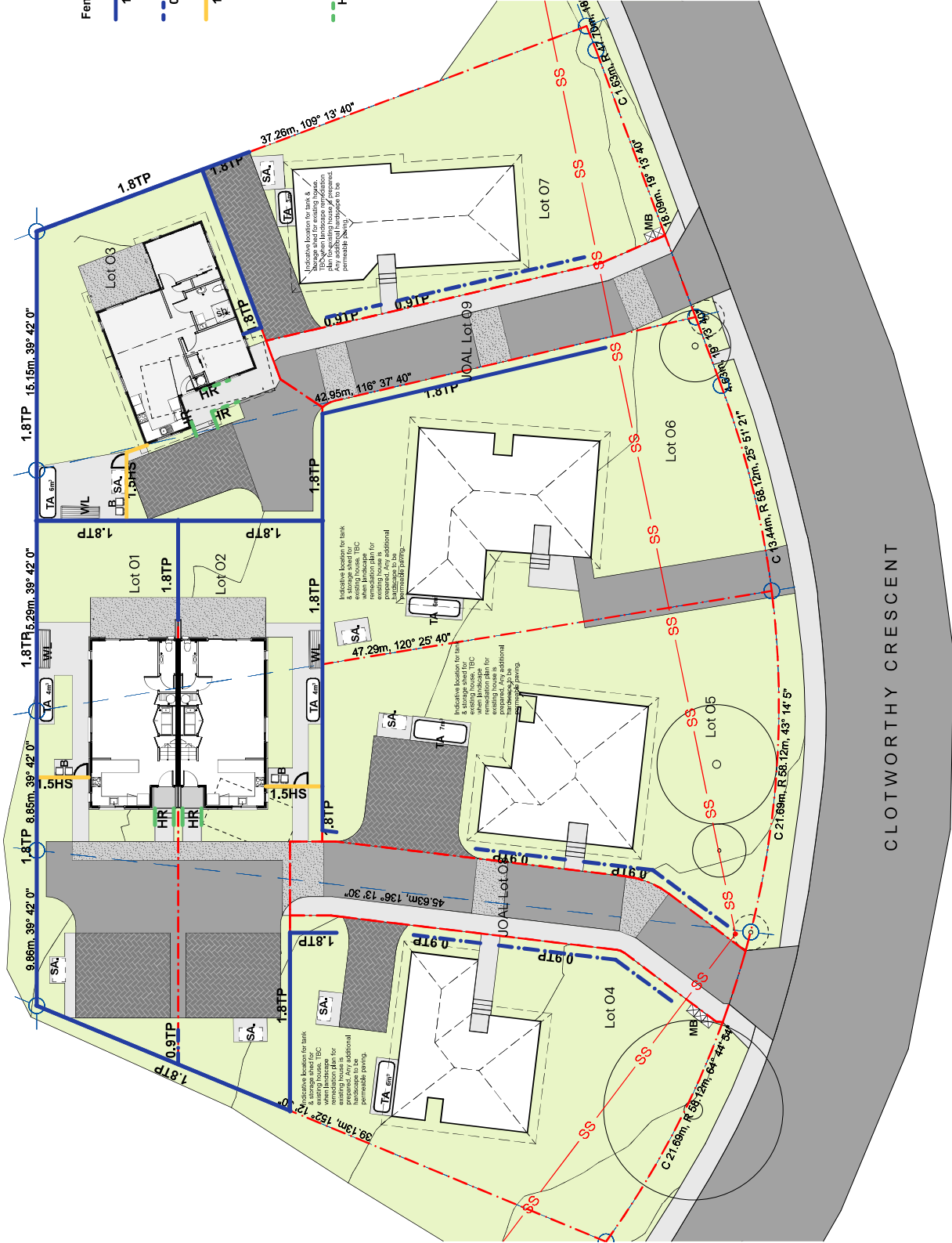

CLOTWORTHY CRESCENT